

# ANIRAJ TOWER

## CO.OP.HSG SOCIETY



P51800024276



Office / Site Address : Aniraj Tower,  
Opp. Kaka Petrol Pump, L.B.S. Marg, Bhandup (W),  
Mumbai - 400 078. Tel. : 91 22 2595 3948  
Telefax : 91 22 2595 3949  
E-mail : info@sudhanshuinfra.in  
Website : www.sudhanshuinfra.in  
CIN No. : U45400MH2008PTC177661

**For Enquiry Contact No. 9819561524 | 8291227227**

Project Register Under Maha Rera Registration no. P51800024276, | website: <https://maharera.mahaonline.gov.in>



# ANIRAJ TOWER

## CO.OP.HSG SOCIETY



GROUND FLOOR PLAN

GROUND FLOOR PLAN

## AMENITIES

1. Club house
  2. Fully Equipped Fitness Centre
  3. Split AC in Hall n Bedroom
  3. Wooden flooring in Master Bedroom
  4. Modular Kitchen
  5. Plumbing & Sanitary Fittings of Reputed Brands
  6. Video Door Phone
  7. Intercom Facility
- ETC.

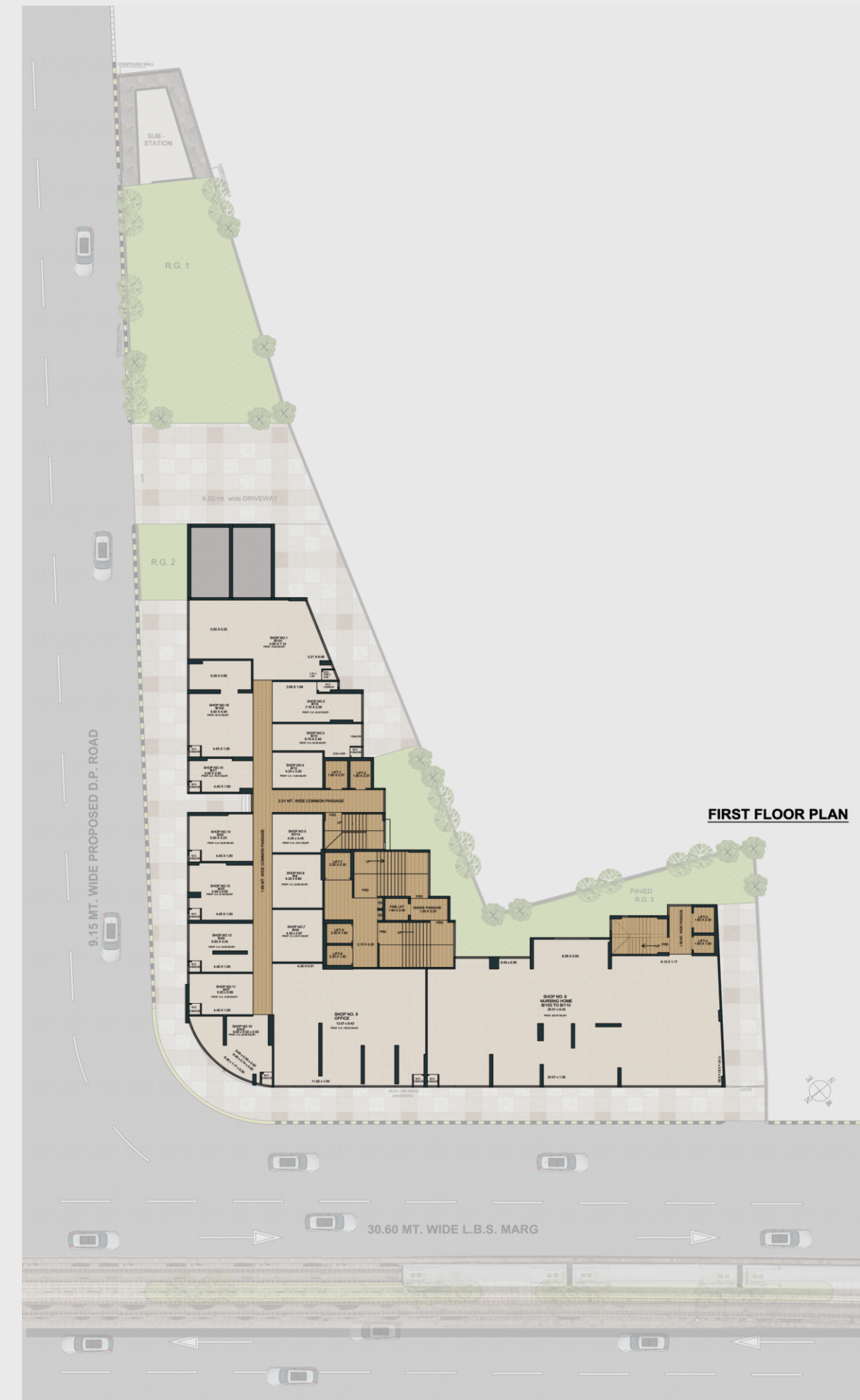
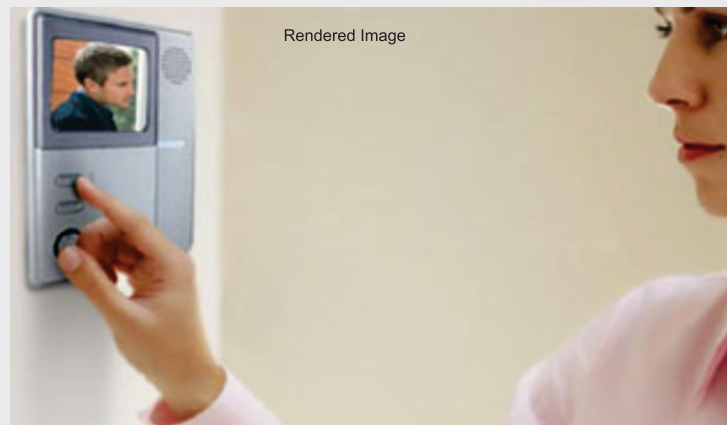

FIRST FLOOR PLAN



SECOND FLOOR PLAN

**REFUGE FLOOR PLAN**

FLAT NO.	TYPE	RERA CARPET AREA
1	2BHK.	576 sq.ft
2	1BHK.	414 sq.ft
5	1BHK.	450 sq.ft
6	2 BHK.	602 sq.ft
7	1.5 BHK.	540 sq.ft



REFUGE FLOOR PLAN  
FLOOR 18TH & 25TH

### TYPICAL FLOOR PLAN

FLAT NO.	TYPE	RERA CARPET AREA
1	2BHK.	576 sq.ft
2	1BHK.	414 sq.ft
3	2 BHK.	650 sq.ft
4	1 BHK.	454 sq.ft
5	1BHK.	450 sq.ft
6	2 BHK.	602 sq.ft
7	1.5 BHK.	540 sq.ft



TYPICAL FLOOR PLAN

16TH, 17TH, 19TH TO 24TH & 26TH TO 29TH



3RD TO 6TH PODIUM FLOOR PLAN



7TH & 8TH FLOOR PLAN

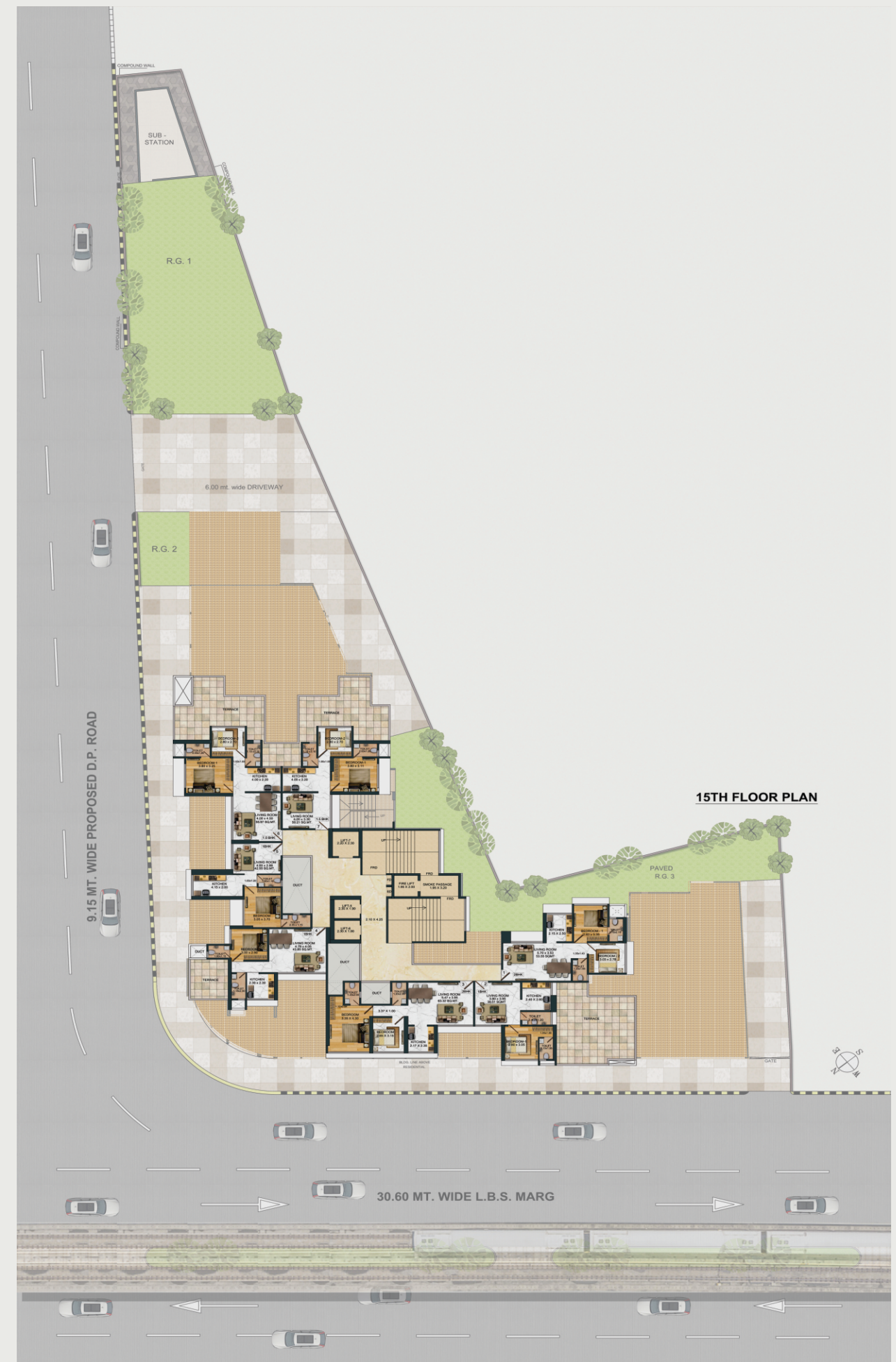

15TH FLOOR PLAN